

**Häcker**  
kitchen.germanMade.

## Häcker Order confirmation



# Training content

1. Front page
2. Header
3. Order processor / After Sales
4. Door Style
5. Item List
6. Floorplan / Elevations



1 (13.P|0) HHK



**>Amendment 2<**  
**CONFIRMATION** dated 10/20/2021  
page: 1/12

Conf.No.	<b>21423355</b>
pick-up date	<b>16.11.21</b>
Means of Transp.	<b>pick-up</b>
Clients Name	<b>KBIS 2022 DISPLAY 1 A978</b>
Order No.	<b>FACTORY TO INSTALL</b>
Order Date	<b>09/28/2021</b> 09/29/2021
Account No.	<b>17765</b> Representative 66
Def.No./VAT-No.	
Customer phone	<b>001-888-861-1019</b>
Email Client	<b>documents@haecker-kuechen.us</b>

Header

HACKER German Kitchen Furniture  
East Inc.  
Suite C, Body 2  
7850 NW 32nd Street  
DORAL FL 33122  
USA

Delivery Address:  
pick-up  
Hacker-Küchen GmbH & Co. KG  
Venne  
Venner Esch 3  
49179 Ostercappeln

Order Processor

Order processor

Mrs. Antje Brökemeier  
(+49) 5748-940-659  
(+49) 5748-940-301  
ABroekemeier@haecker-kuechen.de

After sales service

Mrs. Yasemin Aktas  
(+49) 5748-940-4121  
(+49) 5748-940-301  
YAktas@haecker-kuechen.de

After Sales

Door Style

no further amendments possible

Programme  
**A978**  
**AV 6055 RAL ash**

ash lacquer/frame 86mm

Handle position: **M central**  
Handle/Knob no: **554 handle 160mm stainl. steel col.**

Carcase: **2077 KA: crystal white**  
**KI: crystal white**  
**KK: crystal white**

Dust seal: **N without dust seal**

Plinth height: **13 cm**  
Plinth colour: **973 RAL ash laquered**

Drawer Syst: **75 HACKER glass (soft)-LED, titanium**

Anti-slip-mats: **SA for drawers/pull-outs**  
Mounting parts: **72 titanium**

Worktop profile: **G460 stone with mitred edge 4 cm**

Global Styles

Insofar as orders refer to a colour shade according to the RAL colour guide, we expressly point out that the colours and gloss levels shown there only serve as a rough guide for determining the desired colour shade. This does not constitute a binding agreement on quality. The representation of colour and gloss level on the RAL colour fan refers to an application on the specific material surface to which it has been applied. Due to the use of different material surfaces to which the paint selected according to the RAL colour guide is applied, deviations may occur with regard to both the colour shade and the degree of gloss. This applies in particular to the lacquering of woods and priming papers. Such deviations do not constitute a material defect.

Contains PB or MDF - TSCA Title VI compliant FR89874 - CARB 2 compliant CCR93120.2(a)

Regarding the load securing we refer to the StVZO §§30; 31 as well as

**>Amendment 2<  
CONFIRMATION**

**dated 10/20/2021**  
page: 1/12

Conf.No.	<b>21423355</b>
pick-up date	<b>16.11.21</b>
Means of Transp.	pick-up
Clients Name	<b>KBIS 2022 DISPLAY 1 A978</b>
Order No.	<b>FACTORY TO INSTALL</b>
Order Date	<b>09/28/2021</b> 09/29/2021
Account No.	<b>17765</b> Representative 66
Def-No./VAT-No.	
Customer phone	<b>001-888-861-1019</b>
Email Client	<b>documents@haecker-kuechen.us</b>

The Header provides you  
with all **general information**  
about the kitchen order:

- Häcker confirmation number (21423355)
- Production calendar week
- Customer's name
- Account no.

# Order processor / After Sales



## Order processor:

- Design question
- Re-order question
- Technical question

## Aftersales:

- Reclamation question

## To place an order:

-> [sales@haecker-kuechen.us](mailto:sales@haecker-kuechen.us)

# Door Style



**Häcker**  
kitchen.germanMade.

Programme

**V673**

**1070 GL -putty con.look graphite-**

**lamine structure/edg.lamine**

**AV1070:** Front Style

**V673:** Front color / code

-> V= SystematArt (Handleless)

-> A= Systemat

**GL:** Handleless

# Item List

>Amendment 2<  
CONFIRMATION

Account No: 17765  
HACKER German Kitchen Furniture

Conf.No: 21423355  
Client's Name: KBIS 2022 DISPLAY 1 A978  
Order No: FACTORY TO INSTALL

AV 6055 RAL ash -A978-  
GP:M GB:554 STK:2077 SP:N SH:13 SF:973 SK:75 ARM:SA FEB:72 AP:G460 page: 3/12

Hinges:  
Left/Right

Position  
number

Nomenclature/  
Item code

Quantity

Pos.	Code-No.	H	Qty	Description	Cg	Gross	Net
40	370.020	R	1	1296mm door 386mm pull out 386mm pull out H: 81 13/16" W: 23 5/8" D: 22 1/16" Special tall unit for front dimensions see drawing Carcase: 2059 KA: lava grey KI: lava grey KK: lava grey Programm RAL-Ton: 6003 Olive green with 1296mm door 386mm pull out 386mm pull out H: 81 13/16" W: 23 5/8" D: 22 1/16"	H:2078		
50	W1675260		1	Formed gable end 16mm, for tall units, with edging all around height: 2598 mm (102 5/16") depth: 633 mm (24 colour: 973 RAL ash laquered Oberfläche RAL-Ton: 6003 Olive green H: 102 5/16" W: 5/8" D: 24 15/16"	H:2800 D:750		
/10	SH99		1	Height reduction for gable ends/architecture pi			
/20	SK99		1	Depth reduction for gable ends/architecture pi			
60	WB163778		1	Formed gable end 16mm, for base units, with edging all around height: 780 mm (30 11/16") depth: 280 mm (10 colour: 973 RAL ash laquered Oberfläche RAL-Ton: 1013 Oyster white H: 30 11/16" W: 5/8" D: 10 1/4"	H:980 D:373		
/10	SH99		1	Height reduction for gable ends/architecture pi			
/20	SK99		1	Depth reduction for gable ends/architecture pi			
/30	SP1637		1	Protection profile 373mm, 16mm  protection profile: stainless steel coloured			
70	U607877 (U31A6078D)	L	1	Base unit 600mm, 1 door, 3 interior pull-outs Programm RAL-Ton: 1013 Oyster white interior drawer/pull-out with metal-panel H: 30 11/16" W: 23 5/8" D: 22 1/16"	H:780		
80	U21.2202		1	Special base unit for front dimensions see drawing Programm RAL-Ton: 1013 Oyster white H: 25 9/16" W: 47 1/4" D: 24"	H:650 D:610		
90	WS12061		1	Water protection mat for carcase width 1200mm aluminium metallic			

Details of item **W1675221**,  
which is position number 50

# Item List



>Amendment 2<  
CONFIRMATION

Account No. 17765  
HACKER German Kitchen Furniture

Conf.No. 21423355  
Client's Name KBIS 2022 DISPLAY 1 A978  
Order No. FACTORY TO INSTALL

AV 6055 RAL ash -A978-  
GP:M GB:554 STK:2077 SP:N SH:13 SF:973 SK:75 ARM:SA FEB:72 AP:G460 page: 3/12

Pos.	Code-No.	H	Qty	Description	Cg	Gross	Net
				1296mm door 386mm pull out 386mm pull out H: 81 13/16" W: 23 5/8" D: 22 1/16"			
40	370.020	R	1	Special tall unit for front dimensions see drawing Carcase: 2059 KA: lava grey KI: lava grey KK: lava grey Programm RAL-Ton: 6003 Olive green with 1296mm door 386mm pull out 386mm pull out H: 81 13/16" W: 23 5/8" D: 22 1/16"	H:2078		
50	W1675260		1	Formed gable end 16mm, for tall units, with edging all around height: 2598 mm (102 5/16") depth: 633 mm (24 colour: 973 RAL ash laquered Oberfläche RAL-Ton: 6003 Olive green H: 102 5/16" W: 5/8" D: 24 15/16"	H:2600 D:750		
	SH99		1	Height reduction for gable ends/architecture pi			
	SK99		1	Depth reduction for gable ends/architecture pi			
60	WB163778		1	Formed gable end 16mm, for base units, with edging all around height: 780 mm (30 11/16") depth: 260 mm (10 colour: 973 RAL ash laquered Oberfläche RAL-Ton: 1013 Oyster white H: 30 11/16" W: 5/8" D: 10 1/4"	H:960 D:373		
	SH99	/10	1	Height reduction for gable ends/architecture pi			
	SK99	/20	1	Depth reduction for gable ends/architecture pi			
	SP1637	/30	1	Protection profile 373mm, 16mm ----- protection profile: stainless steel coloured -----			
70	U607877 (U31A6078D)	L	1	Base unit 600mm, 1 door, 3 interior pull-outs Programm RAL-Ton: 1013 Oyster white interior drawer/pull-out with metal-panel H: 30 11/16" W: 23 5/8" D: 22 1/16"	H:760		
80	U21.2202		1	Special base unit for front dimensions see drawing Programm RAL-Ton: 1013 Oyster white H: 25 9/16" W: 47 1/4" D: 24"	H:650 D:610		
90	WS12061		1	Water protection mat for carcass width 1200mm aluminium metallic			

- Position number 50 (main item) contains two sub-positions: 50/10 & 50/20
- These items (50/10&50/20) are a component part to the main item (Pos.50)
- 50/10: Height reduction
- 50/20: Depth reduction



# Item List

>Amendment 2<  
**CONFIRMATION**

**Häcker**  
kitchen.german Made.  
dated 10/20/2021

Account No. **17765**  
HACKER German Kitchen Furniture

Conf.No. **21423355**  
Client's Name **KBIS 2022 DISPLAY 1 A978**  
Order No. **FACTORY TO INSTALL**

**AV 6055 RAL ash -A978-**  
GP:M GB:554 STK:2077 SP:N SH:13 SF:973 SK:75 ARM:SA FEB:72 AP:G460 page: 10/12

Pos.	Code-No.	H	Qty	Description	Cg	Gross	Net
840	SO1		1	Plinth panel Oberfläche RAL-Ton: 6003 Olive green H: 5 1/8" W: 70 7/8" E 1200 E (47 1/4")			
/10							
/20	SB171		1	Return plinth, depth x height D:658 depth: <b>658 mm (25 7/8")</b>			
/30	SB171		1	Return plinth, depth x height D:658 depth: <b>658 mm (25 7/8")</b>			
/40				E 600 E (23 5/8")			
850	SO1		1	Plinth panel Oberfläche RAL-Ton: 1013 Oyster white H: 5 1/8" W: 311"			
/10	SB171		1	Return plinth, depth x height D:658 depth: <b>658 mm (25 7/8")</b>			
/20				E 1800 E LAM(70 7/8")			
/30				LAM E 1100 E (43 5/16")			
/40	SB171		1	Return plinth, depth x height D:658 depth: <b>658 mm (25 7/8")</b>			
/50	SB171		1	Return plinth, depth x height D:658 depth: <b>658 mm (25 7/8")</b>			
/60				E 600 E (23 5/8")			
/70	SB191		1	Return plinth, variable depth: <b>1016 mm (40")</b>			
/80				E 2200 E (86 5/8")			
/90	SB191		1	Return plinth, variable depth: <b>1016 mm (40")</b>			
/100				E 2200 E (86 5/8")			
961	* BP-KEHL		1	Sundries - Channel handles			
/10	* BP034		4	Outside corner 270° for channel handle L-shaped			
/20	* BP035		16	Channel handle: <b>320 stainless steel col. brush-finished</b> Fastening angle for channel handle			
967	* BP-LI-KEHL		1	Sundries - lighting profile			
/10	* BP064		4	Channel handle cable duct white, 500mm for LED-Profile			
/20	* BP070		4	Cap for LED profile set (left/right) for profile with fixing			
968	BP-ARM		1	Anti-slip-mat			
/10	ARM-10035		2	1000mm Anti-slip-mat for drawers and pull-outs	D:350		
/20	ARM-5056		6	500mm Anti-slip-mat for drawers and pull-outs	D:560		
/30	ARM-5056		2	500mm Anti-slip-mat for drawers and pull-outs	D:560		
/40	ARM-5556		3	550mm Anti-slip-mat for drawers and pull-outs	D:560		
/50	ARM-6056		6	600mm Anti-slip-mat for drawers and pull-outs	D:560		
/60	ARM-6056		10	600mm Anti-slip-mat for drawers and pull-outs	D:560		
/70	ARM-6056		1	600mm Anti-slip-mat for drawers and pull-outs	D:560		
969	BP-ARM2		1	Anti-slip-mat			
/10	ARM-10071		3	1000mm Anti-slip-mat for drawers and pull-outs	D:710		

- You will find the **molding** (crown, toe-kick etc.) and **channel handle at the end of the confirmation**
- **Sundries (start with 'BP')** are also at the end of the confirmation. These parts don't have to be ordered, they automatically come with the order (such as cabinet feet, end caps for channel handle etc.)
- **Accessories** like cutlery trays are usually confirmed right after the cabinet that they are meant for

# Florplan

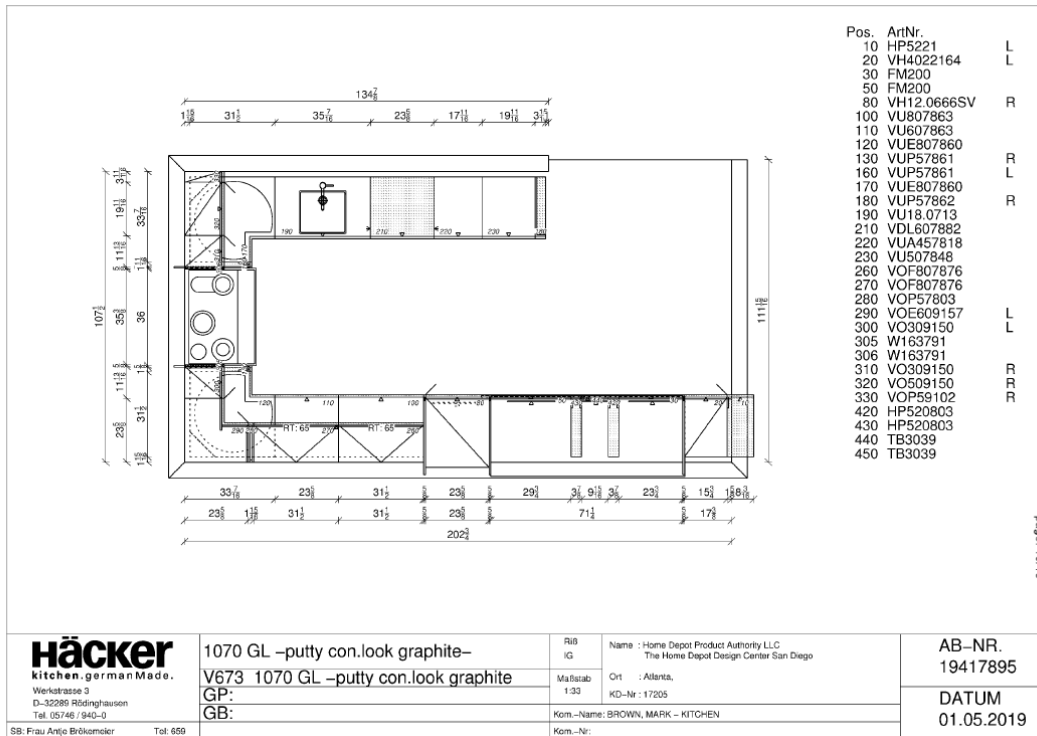

- The floorplan shows the position numbers
- The order of the position numbers is NOT random
- We usually confirm all items from **left to right**
- Starting with the base- and tall cabinets, then upper cabinets
- **Accessories are not shown** on the drawing

# Elevations

- The elevations show **item codes** and **exact measurements** for each individual cabinet

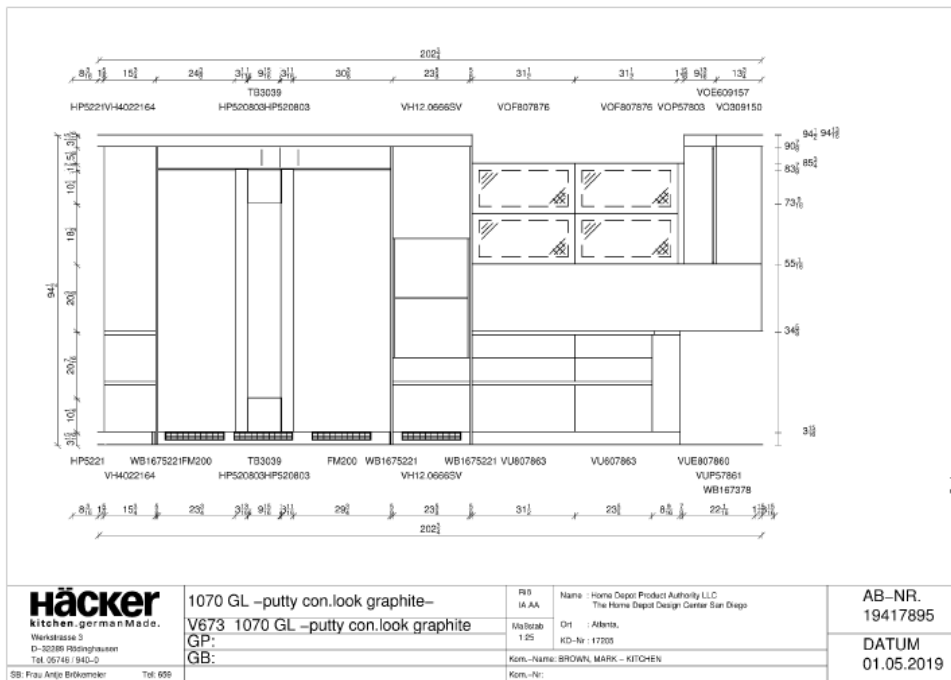

<b>Häcker</b> kitchen.german Made. Werkstätte 3 D-30389 Fähringhausen Tel. 05746 / 840-0 SB: Frau Anja Bröckmeier Tel: 699	1070 GL –putty con.look graphite–	FR IA.AA	Name: Home Depot Product Authority LLC The Home Depot Design Center San Diego	AB-NR. 19417895
	V673 1070 GL –putty con.look graphite	Maßstab 1:25	Ort: Atlanta KD-Nr.: 17203	DATUM 01.05.2019
	GP: GB:	Kom.-Name: BROWN MARK – KITCHEN Kom.-Nr.:		

# Open discussion & questions



Thank you for your attention

